

Setup Manual

Introduction

The HMI comes with high-resolution TFT display module and a IP65 waterproof grade. The elegance in its design coupled with the flexibility of the nHMI Developer meets user satisfaction in any application requirement.

Warning

Please read this manual before continuing with installation or operation of the device.

General Guide

- Installation and operation of the device must be done by professionally trained staff.
- Installation of the device must follow the instructions as printed in this manual.
- If installation of the device occurs outside the suggested storage temperature range of the device, it may cause the LCD to malfunction.
- If installation of the device occurs outside the suggested storage humidity range of the device, it may cause the touch panel to accumulate moisture which may shorten its product lifespan.
- Installation of the device must be kept away from the risk of any liquid or metal particles getting into the device. Foreign particles may cause internal components to short circuit and thus damage the device or even catch fire.
- The device must be installed on a stable and flat surface.
- Installation of the device must be kept away from the risk of corrosion, explosion, or heavy electronic and magnetic fields. It must also be kept away from high humidity and extreme shifts in temperature.
- The liquid in the LCD screen is very hazardous. If leakage is found, avoid contact with skin. At the chance of accidental contact, please immediately rinse with water. If the material comes in contact with eyes, please use water to rinse out the material and immediately seek medical assistance.
- Nearby equipment must be installed at a safe and appropriate distance with adequate protection to reduce local interference with the device.

Power Supply

- The device is designed with an input power of DC 24V. If the supply voltage is outside of the DC 24V +/- 20% range, it may result in damage or malfunction to the device. Therefore, please confirm that the voltage is correct before powering the device on. Please also ensure that the supplied power is stable during device operation.

Installation:

- Please avoid placing communication lines in the same conduit as the power lines and high voltage lines. Isolated lines are suggested to reduce surrounding noise interference.

Operation

- The device should not be used as a main control trigger for any emergency override or safety-related operations.
- Please note that the touch panel on the device is made of standard glass. Please do not use forceful pressure or sharp objects to contact or hammer the screen.

Service and Maintenance

- Please do not allow any non-trained staff members to perform the maintenance servicing.
- Loosen the three screws on the power plug.
- Strip the cable to expose the copper wire to about 7-8mm.
- Insert the exposed copper wire into the three openings on the power plug.
- Retighten the three screws on the power plug.
- Plug the power plug back into the power terminal of the device.

Waste and Recycling

- Please adhere to local regulations when recycling device.
- The screen, lithium battery, and capacitors contain hazardous material to individual health and local environment, and must be disposed responsibly.

Grounding

In order to maintain the operational condition and functioning of the HMI hardware components, please ensure proper power grounding. Please ensure that the cable connecting the FG power terminal to the ground has a cable resistance lower than 100Ω.

Installation Parts

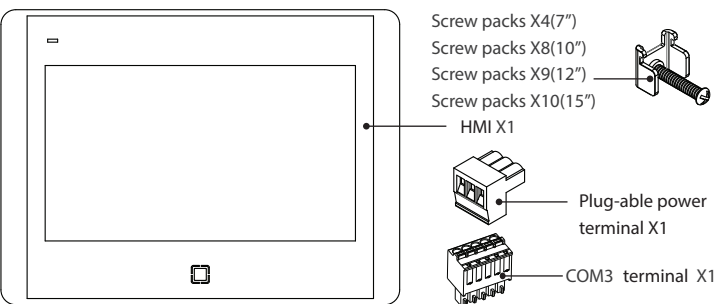

Housing Type and Cut-Out Dimension

*07M(ODM)/10M(Standard)

*12M(ODM)/15M(ODM)

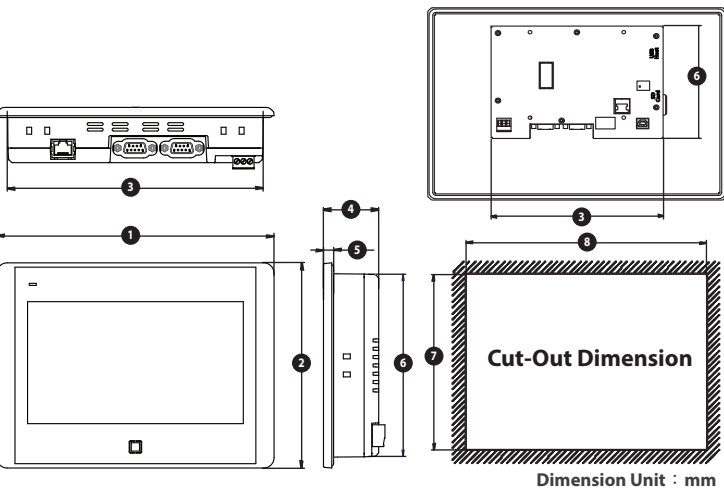

	1	2	3	4	5	6	7	8
7"	199.83	147.83	184.10	39.80	7.45	132.10	133.20	185.20
10.2"	279.48	195.48	259.17	39.50	7.45	176.15	177.20	260.20
12.1"	319.00	225.00	185.50	50.60	6.00	131.50	211.70	305.70
15.6"	408.80	260.90	185.50	50.60	6.00	131.50	246.62	394.50

Installing Procedure

- Check the cut-out size of the device then make the proper cut-out on the setting plate. Lodge the device into the cut-out on the setting plate. (Unit = mm).
- Fasten the device to the setting plate by tightening the screws on the back of the device. Please tighten all screws evenly instead of tightening each screw one by one. If the screws are not tightened evenly, it may cause distortion damage to the device.

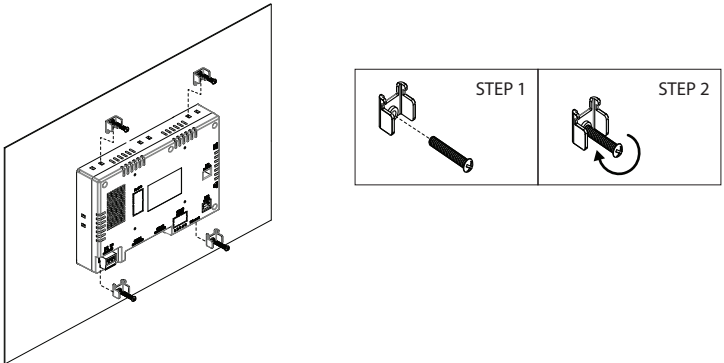

Power Connection

The device requires a power voltage of DC 24V (+/-20%). For a power consumption of 8W on the 7" device, a power supply of 10W or above is recommended. For a power consumption of 10W on the 10" device, a power supply of 12W or above is recommended. For a power consumption of 22W on the 12" device, a power supply of 24W or above is recommended. For a power consumption of 28W on the 15" device, a power supply of 30W or above is recommended.

Importance Notice

It is recommended that the power plug must be connected to the device power terminal prior to connecting to the power source.

Power-connecting steps

- Remove the power plug from the power terminal of the device.
- Loosen the three screws on the power plug.
- Strip the cable to expose the copper wire to about 7-8mm.
- Insert the exposed copper wire into the three openings on the power plug.
- Retighten the three screws on the power plug.
- Plug the power plug back into the power terminal of the device.

Note

The power plug is included and already plugged into the power terminal of the device.

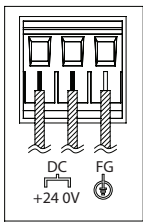

Power Line Type	Power Line (AWG)	Strip Length	Torque
Solid	28-12	About 7-8 mm	About 4.5 lb-in
Stranded	30-12	About 7-8 mm	About 4.5 lb-in

* with copper conduction wire only.

Instructional Diagram

*07M(ODM)/10M(Standard)

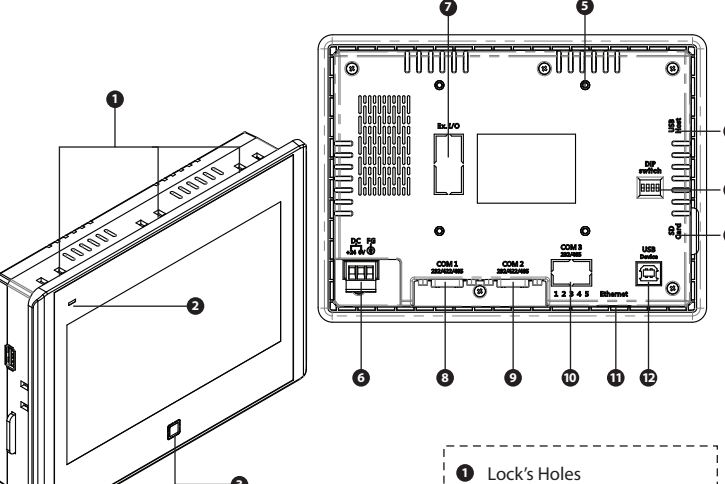

*12M(ODM)
15M(ODM)

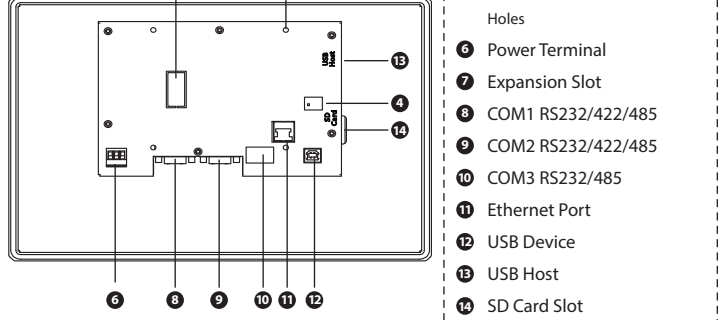

Product Specification

Type	M Series			
Model Number	07M(ODM)	10M(Standard)	12M(ODM)	15M(ODM)
Display Type	7" TFT	10.2" TFT	12.1" TFT	15.6" TFT
Resolution	800x480	800x480	1280x800	1366x768
Color	16.7M			
Backlight Type	LED			
Brightness	250 cd/m ²	350 cd/m ²	600 cd/m ²	500 cd/m ²
Contrast	500:1	300:1	1000:1	600:1
CPU	ARM Cortex-A8 (1GHz)			
Flash Memory	4GB, 8bit eMMC			
RAM	512M Bytes			
FRAM (non-volatile)	32K Bytes			
RTC	CR2032 Replaceable			
COM1	RS232/422/485			
COM2	RS232/422/485			
COM3	RS232/485 or CAN Bus (Option)			
Ethernet	1 x 10/100 Mbit (Default) ; 2 x 10/100 Mbit (Option)			
USB	1 x Type A (Host), 1 x Type B (Device)			
Memory Card	SD Card			
Power Supply	24V ± 20% DC, Isolated Power			
Power Consumption	8 W	10 W	22 W	28 W
Operation Temperature	0 ~ 50 ℃			
Storage Temperature	-20 ~ 60 ℃			
Operation Humidity	10 ~ 90%RH No Condensation @40 ℃			
Dimension(mm)	199.8 x 147.8 x 39.8	279.5 x 195.5 x 39.5	319.0 x 225.0 x 50.6	408.8 x 260.9 x 50.6
Cut-out Dimension (mm)	185.2 x 133.2	260.2 x 177.2	305.7 x 211.7	395.5 x 247.6
(Net) Weight	0.66 kg	1.12 kg	2.2 kg	3.1 kg
Net weight with Packing box	0.98 kg	1.54 kg	2.8 kg	4.0 kg
Touch Panel	4-wire Resistive		5-wire Resistive	

Power On Test

At power on, the device should automatically perform a system diagnostic test. The diagnostic summary at the end of the testing will display a if no issues are detected, and a if an error is detected. Press [Continue] to jump to the System Menu Screen. If there are no errors detected, the "Continue" option will not show.

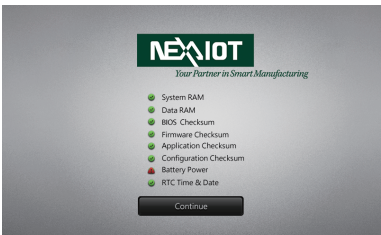

System Menu Screen

Click [Run Application] to start up any applications downloaded to the device. Click [Settings] for BIOS options such as backlight brightness, Ethernet settings, and etc. Click [Enable USB Device Transfer] for options such as communication interface and download/upload application.



Ethernet Setting

Ethernet settings include [IP Address], [Gateway], [Netmask], [Port] and [DHCP]. In order to ensure a smooth and stable connection, communication parameters must correspond with the connecting controller. Click the IP address field to enter the IP address. The IP address should follow the format: XXX.XXX.XXX.XXX. Each XXX should be less than or equal to "255". The system will automatically jump to the next set of XXX if values are accepted (if the input value is greater than 255, the system will require users to re-enter values). Press the key to jump to the next set of XXX values and the key to edit a previous set.

When [DHCP] is activated, the system will automatically assign IP to the HMI according to the network.

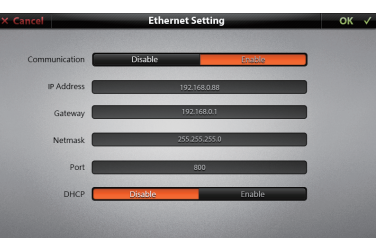

File Transfer

Applications and firmware can be downloaded or uploaded via USB, SD card or FTP. Select for the application or firmware to be transferred from the HMI to the memory card. Select for the application or firmware to be transferred from the memory card to the HMI. Click [OK] to begin file selection process.

